

Proposed by Washington Grove
Studied by MCDOT

SHEET NO.	TOTAL SHEETS
04	11

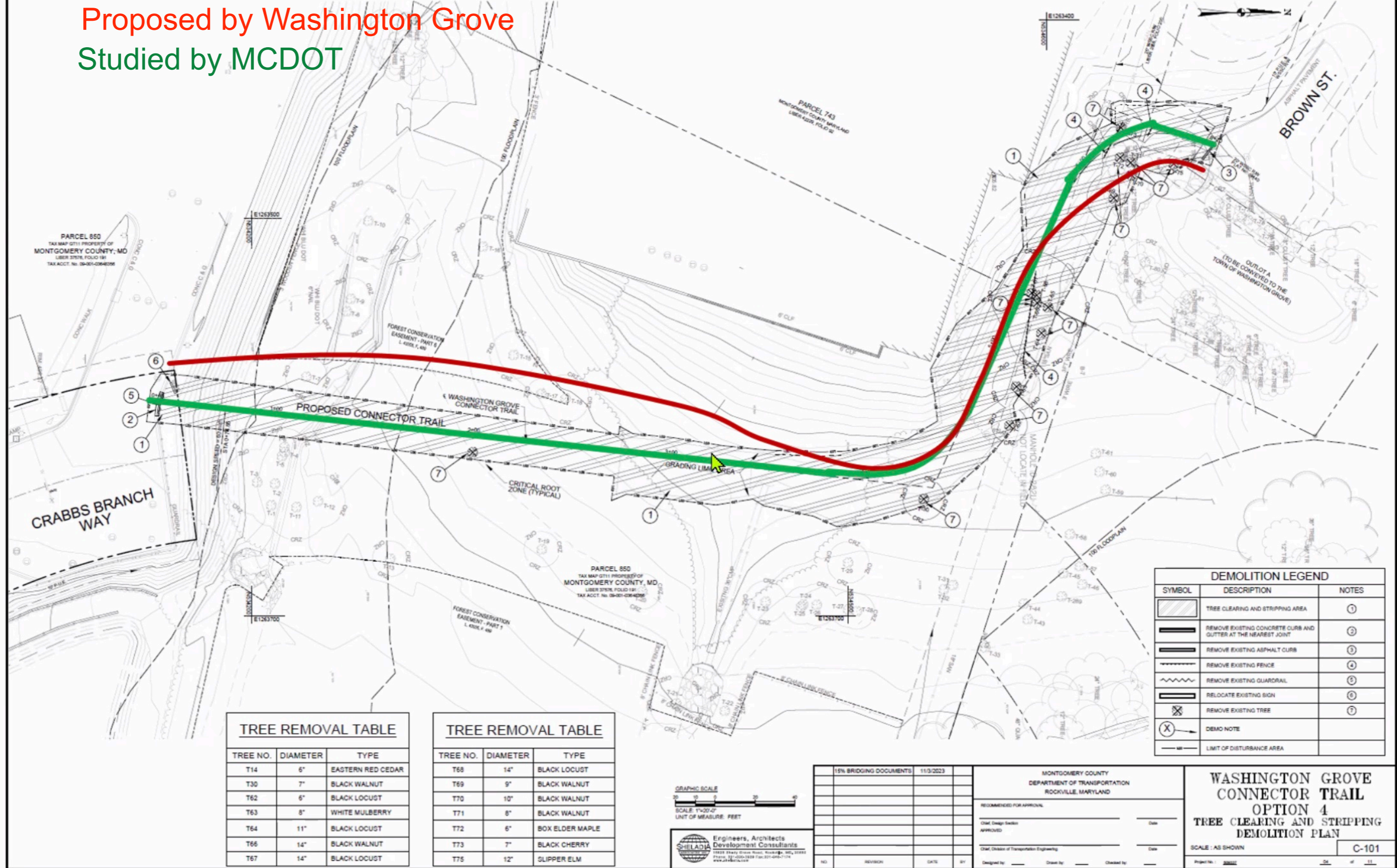

TREE NO.	DIAMETER	TYPE
T14	6"	EASTERN RED CEDAR
T30	7"	BLACK WALNUT
T62	6"	BLACK LOCUST
T63	8"	WHITE MULBERRY
T64	11"	BLACK LOCUST
T66	14"	BLACK WALNUT
T67	14"	BLACK LOCUST

TREE NO.	DIAMETER	TYPE
T68	14"	BLACK LOCUST
T69	9"	BLACK WALNUT
T70	10"	BLACK WALNUT
T71	8"	BLACK WALNUT
T72	6"	BOX ELDER MAPLE
T73	7"	BLACK CHERRY
T75	12"	SLIPPER ELM

DEMOLITION LEGEND		
SYMBOL	DESCRIPTION	NOTES
	TREE CLEARING AND STRIPPING AREA	①
	REMOVE EXISTING CONCRETE CURB AND GUTTER AT THE NEAREST JOINT	②
	REMOVE EXISTING ASPHALT CURB	③
	REMOVE EXISTING FENCE	④
	REMOVE EXISTING GUARDRAIL	⑤
	RELOCATE EXISTING SIGN	⑥
	REMOVE EXISTING TREE	⑦
	DEMO NOTE	
	LIMIT OF DISTURBANCE AREA	

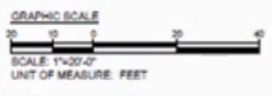

15% BRIDGING DOCUMENTS	11/3/2023				
MONTGOMERY COUNTY DEPARTMENT OF TRANSPORTATION ROCKVILLE, MARYLAND					
RECOMMENDED FOR APPROVAL:					
Chief Design Engineer		Date:			
APPROVED:					
Chief, Division of Transportation Engineering		Date:			
Designed by:	Drawn by:	Checked by:			

WASHINGTON GROVE CONNECTOR TRAIL
OPTION 4
TREE CLEARING AND STRIPPING DEMOLITION PLAN

SCALE: AS SHOWN

C-101

Project No: 202001

Sheet No: 04 of 11

FILE: K:\647 MC DOT\4 Crabbs Branch Facility Planning Phase II\Engineering\6 CAD\Conceptual 15 Design\REPORTS\OPTION4\OPTION 4-C-101.dwg