

## Washington Grove Connector Shared Use Path Report May 18, 2024

DOT has begun seeking approvals for the Connector that are necessary for the required Mandatory Referral (MR) meeting with Maryland National Capital Park and Planning Commission (M-NCPPC). That meeting occurs once the 35% completion of the design has been reached and approvals are obtained for forest conservation exemption by M-NCPPC and a stormwater concept plan. Once the application is submitted, M-NCPPC through Montgomery County Planning Board has 60 days to review. MCDOT is aiming for the mandatory referral hearing by the Planning Board to be October. At the time of mandatory referral, Washington Grove and any other interested parties can submit comments. Here is general information about [mandatory referral](#).

Comments from the Planning Board that result from the MR meeting are considered and, if appropriate, incorporated into the design. In the next design phase, review and permits will be required from WSSC and from the Maryland Department of the Environment (for wetland and floodplains). Plans are completed and right of way is secured before construction. No timeline has been provided for any of the work following mandatory referral.

In March, DOT has inquired about property acquisition or easement at the end of Brown St. This is something that can be worked on by the town while DOT does its work. Barbara Raimondo suggested asking the town attorney for assistance with this issue.

In late April the Mayor submitted [a letter to County Council in support of the Connector construction for FY 25 \(PDF\)](#). In mid-May Council approved the draft 2025 budget which includes minor bikeways projects such as the WG Connector among the capital improvements projects. As of May 18<sup>th</sup>, I have been unable to determine if the Connector was in fact included.

Finally, in early April, Gaithersburg provided a preliminary plan of the portion of a shared use path across the commercial corner to Brown St. (attached).

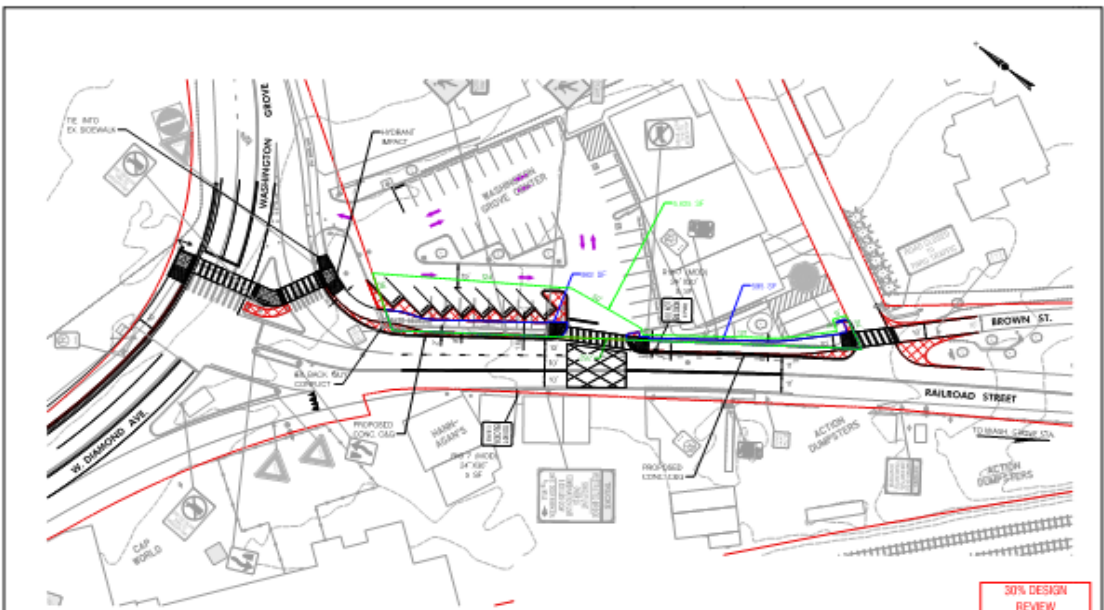

30% DESIGN REVIEW  
NOT FOR CONSTRUCTION

Proposed Shared Use Path	Proposed Shared Use Path
Proposed Shared Use Path	Proposed Shared Use Path
Proposed Shared Use Path	Proposed Shared Use Path

**Mead & Hunt**  
 1000 GAITHERSBURG ROAD, SUITE 100  
 GAITHERSBURG, MD 20878  
 TEL: 301.251.1000  
 WWW.MEADANDHUNT.COM

NO. 1	NO. 2	NO. 3	NO. 4	NO. 5	NO. 6	NO. 7	NO. 8	NO. 9	NO. 10

**NOTES**  
 1. ALL CONSTRUCTION SHALL BE IN ACCORDANCE WITH THE CITY OF GAITHERSBURG STANDARD SPECIFICATIONS FOR PUBLIC WORKS, LATEST EDITION.  
 2. THE SHARED USE PATH SHALL BE CONSTRUCTED TO THE CENTERLINE OF THE PROPOSED RIGHT-OF-WAY.  
 3. THE SHARED USE PATH SHALL BE CONSTRUCTED TO THE CENTERLINE OF THE PROPOSED RIGHT-OF-WAY.  
 4. THE SHARED USE PATH SHALL BE CONSTRUCTED TO THE CENTERLINE OF THE PROPOSED RIGHT-OF-WAY.  
 5. THE SHARED USE PATH SHALL BE CONSTRUCTED TO THE CENTERLINE OF THE PROPOSED RIGHT-OF-WAY.  
 6. THE SHARED USE PATH SHALL BE CONSTRUCTED TO THE CENTERLINE OF THE PROPOSED RIGHT-OF-WAY.  
 7. THE SHARED USE PATH SHALL BE CONSTRUCTED TO THE CENTERLINE OF THE PROPOSED RIGHT-OF-WAY.  
 8. THE SHARED USE PATH SHALL BE CONSTRUCTED TO THE CENTERLINE OF THE PROPOSED RIGHT-OF-WAY.  
 9. THE SHARED USE PATH SHALL BE CONSTRUCTED TO THE CENTERLINE OF THE PROPOSED RIGHT-OF-WAY.  
 10. THE SHARED USE PATH SHALL BE CONSTRUCTED TO THE CENTERLINE OF THE PROPOSED RIGHT-OF-WAY.

DATE	DESCRIPTION

PROJECT TITLE	PROJECT LOCATION	PROJECT NUMBER	PROJECT DATE
SHARED USE PATH PLAN	OLDE TOWNE TO WASHINGTON GROVE		
	SHARED USE PATH		
	CITY OF GAITHERSBURG		